



Gas Control Valve

Alloy - Aluminum 357

Temper – T5

Leak tight, gas.



Master Cylinder

Alloy - Aluminum 357

Temper – T5

Leak tight, pressure to 5,000 psi.



Anti-lock Brake System (ABS) Valve

Alloy - Aluminum 357

Temper – T5

Automotive application, pressure tight.

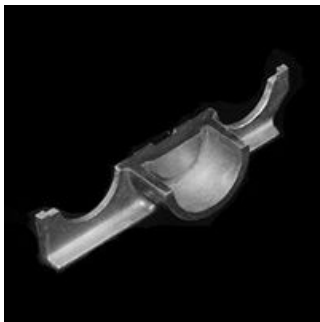

Missile Connector Support

Alloy - Aluminum 357

Temper – T5

Defense application, pressure tight.

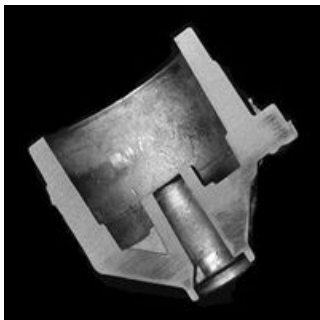

Automotive Steering Pump

Alloy - Aluminum 380

Temper – F

Conversion from a diecasting for higher internal soundness and quality.